

MICROceL™ OX Miniature Oxygen Sensor

N.B. All performance data is based on conditions at 22°C, 50%RH, and 1014mBar

Performance Characteristics

Expected Operating Life	2 Years in Air
Range	0-25% O ₂
Maximum Overload	30% O ₂
Output Signal	40-70µA in Air
T₉₀ Response Time	< 15 seconds (typically 3-4 seconds)
Linearity	$s = k \log_e 1/(1-c)$
Temperature Range	-20°C to +50°C
Temperature Coefficient	0.2% signal change/°C (see graph overleaf)
Humidity (Intermediate) (Continuous)	0-99% RH non-condensing 15-90% RH non-condensing
Pressure Range	Atmospheric ±10%
Pressure Coefficient	<0.02% signal/mBar
Long Term Drift	<10% signal loss/year
Recommended Load Resistor	<100 Ohms (See graph overleaf)

Physical Characteristics

Weight	8g approx.
Position Sensitivity	None
Storage Life	Six months in CTL packaging
Recommended Storage Temperature	0°C to 20°C
Warranty Period	24 months from date of despatch (This amounts to a variation of condition 6 of our standard terms and conditions which otherwise apply)

Outline Dimensions

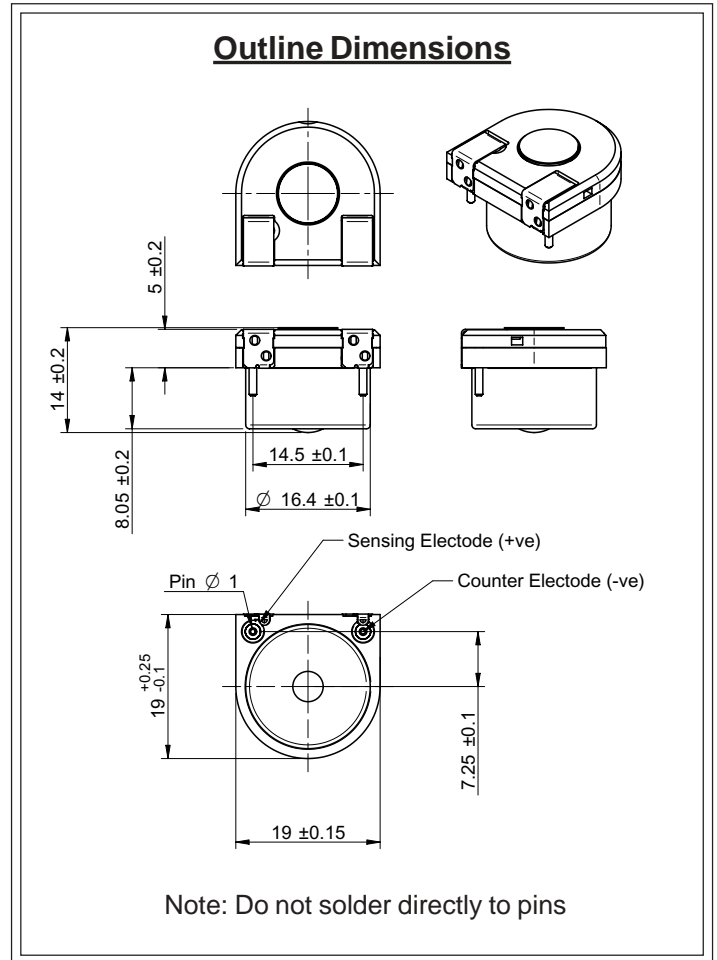

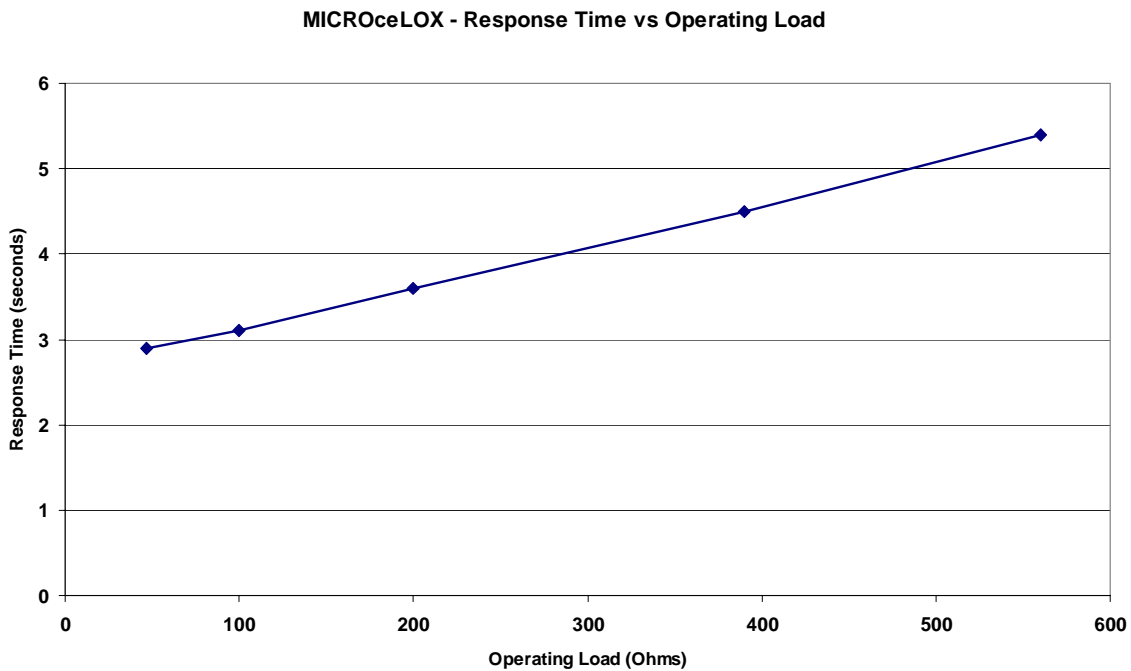
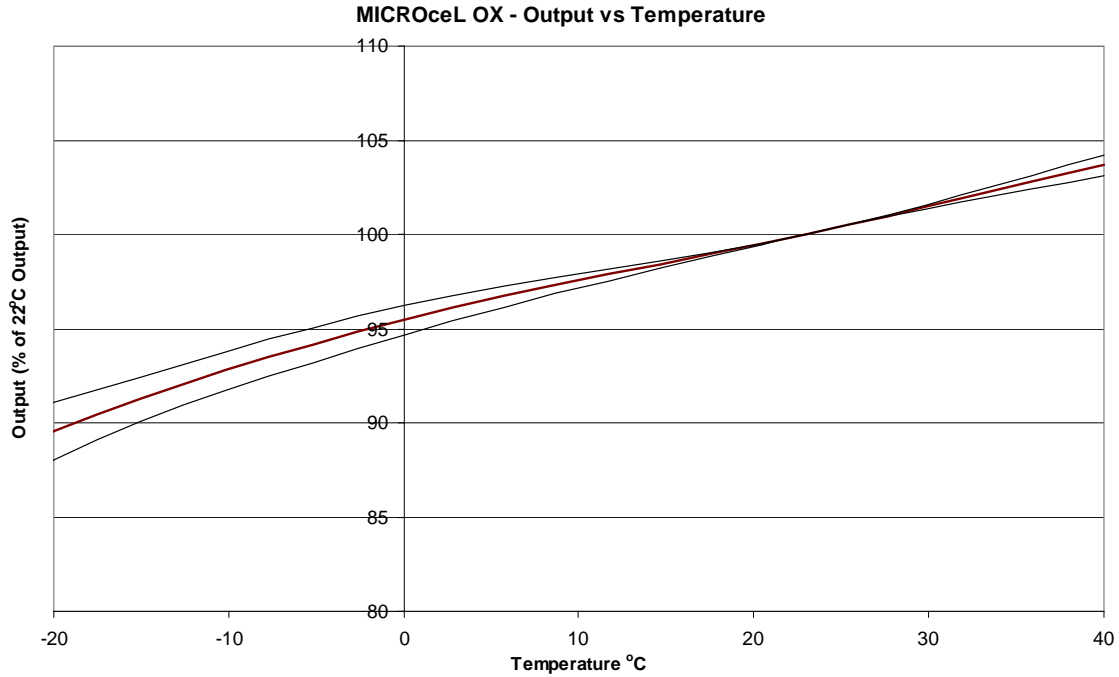

Every effort has been made to ensure the accuracy of this document at the time of printing. In accordance with the company's policy of continued product improvement City Technology Limited reserves the right to make product changes without notice. No liability is accepted for any consequential losses, injury or damage resulting from the use of this document or from any omissions or errors herein. The data is given for guidance only. It does not constitute a specification or an offer for sale. The products are always subject to a programme of improvement and testing which may result in some changes in the characteristics quoted. As the products may be used by the client in circumstances beyond the knowledge and control of City Technology Limited, we cannot give any warranty as to the relevance of these particulars to an application. It is the clients' responsibility to carry out the necessary tests to determine the usefulness of the products and to ensure their safety of operation in a particular application. Performance characteristics on this data sheet outline the performance of newly supplied sensors. Output signal can drift below the lower limit over time.

